

S COLLIER

2 DEMI-COQUILLES

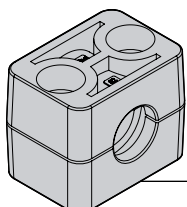

TYPE 2

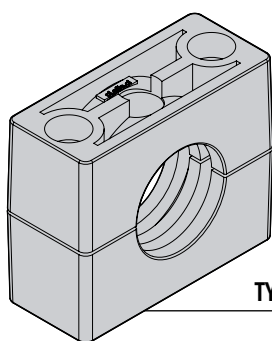

TYPE 3

Code S (Matière PP - PA - GM - AU)

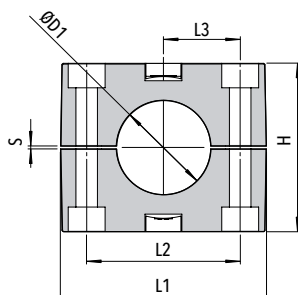
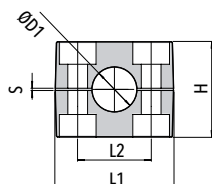

CODE DE DÉSIGNATION

CODE COLLIER	DIAMÈTRE EXTÉRIEUR (mm)	MATIÈRE
--------------	-------------------------	---------

EXEMPLE

Collier type: 2
 Matière: PP
 Diamètre extérieur: 15 mm
 Code de désignation: **S2 - 15 - PP**

Code	Diamètre extérieur ØD1		L1	L2	L3	H	S	Largeur
	mm	nominal gaz						
	8							
	10	1/8"						
	12							
S2	14		43	26	---	33	0,8	30
	15							
	16							
	17,2	3/8"						
	18							
	20							
	21,3	1/2"						
	22							
	23							
	25							
	26,9	3/4"						
S3	28		70	52	26	57	1	30
	30							
	32							
	33,7	1"						
	35							
	38							
	40							
	42,4	1.1/4"						

PP PLAQUE À SOUDER SIMPLE

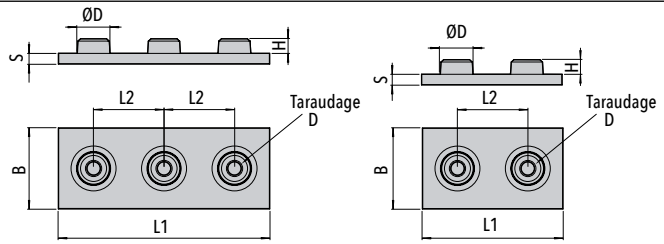

Code	L1	L2	B	S	H	ØD	Taraudage D
------	----	----	---	---	---	----	-------------

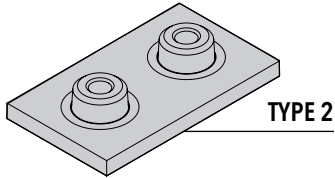
**PP2
XPP2**

52

26

30

4

5,5

12

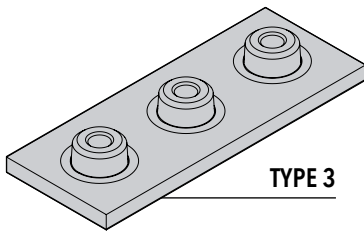
**M6
(1/4-20 UNC)**

**PP3
XPP3**

78

26

30

4

5,5

12

**M6
(1/4-20 UNC)**
Code PP (Acier S 235 JR)

Code XPP (Inox 316L).

60

PA PLAQUE À SOUDER SIMPLE CORNIÈRE

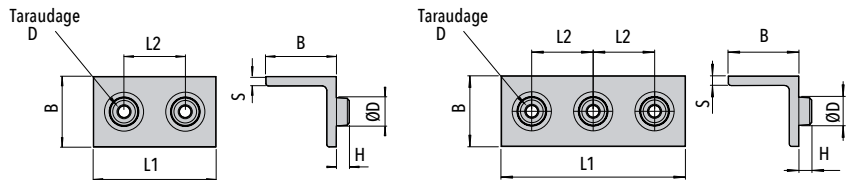

Code	L1	L2	B	S	H	ØD	Taraudage D
------	----	----	---	---	---	----	-------------

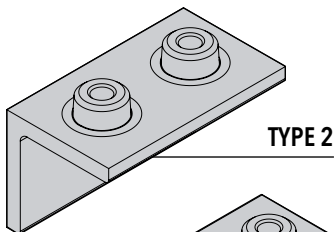
**PA2
XPA2**

52

26

30

4

5,5

12

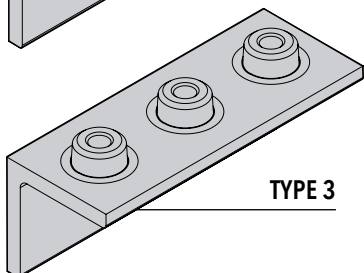
**M6
(1/4-20 UNC)**

**PA3
XPA3**

78

26

30

4

5,5

12

**M6
(1/4-20 UNC)**
Code PA (Acier S 235 JR)

Code XPA (Inox 316L).

PPM

PLAQUE À SOUDER MULTIPLE

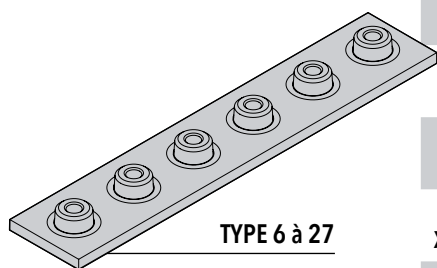
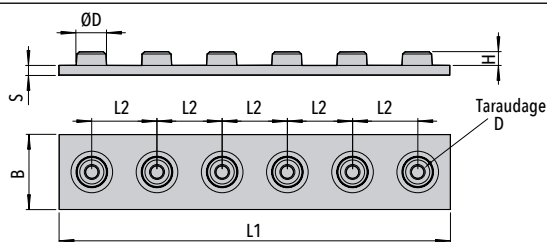

TYPE 6 à 27

Code	L1	L2	B	S	H	ØD	Taraudage D
PPM5 XPPM5	130	26	30	4	6	12	M6 (1/4-20 UNC)
PPM6 XPPM6	156	26	30	4	6	12	M6 (1/4-20 UNC)
PPM7 XPPM7	182	26	30	4	6	12	M6 (1/4-20 UNC)
PPM9 XPPM9	234	26	30	4	6	12	M6 (1/4-20 UNC)
PPM12 XPPM12	312	26	30	4	6	12	M6 (1/4-20 UNC)
PPM15 XPPM15	390	26	30	4	6	12	M6 (1/4-20 UNC)
PPM20 XPPM20	520	26	30	4	6	12	M6 (1/4-20 UNC)
PPM27 XPPM27	702	26	30	4	6	12	M6 (1/4-20 UNC)

Code PPM (Acier S 235 JR)
Code XPPM (Inox 316L).

PAM

PLAQUE À SOUDER MULTIPLE CORNIÈRE

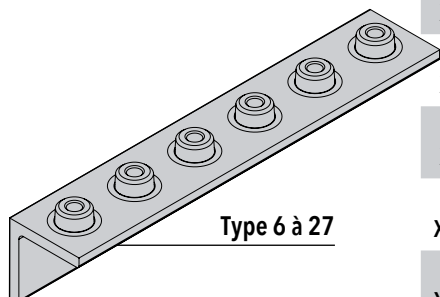
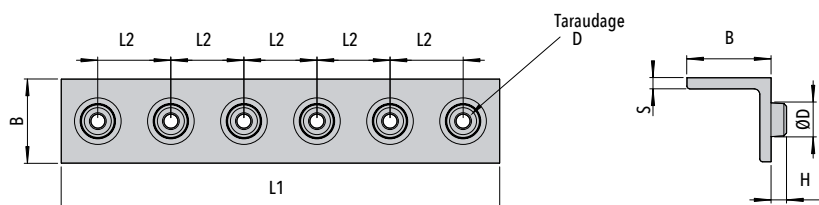

Type 6 à 27

Code	L1	L2	B	S	H	ØD	Taraudage D
PAM5 XPAM5	130	26	30	4	6	12	M6 (1/4-20 UNC)
PAM6 XPAM6	156	26	30	4	6	12	M6 (1/4-20 UNC)
PAM7 XPAM7	182	26	30	4	6	12	M6 (1/4-20 UNC)
PAM9 XPAM9	234	26	30	4	6	12	M6 (1/4-20 UNC)
PAM12 XPAM12	312	26	30	4	6	12	M6 (1/4-20 UNC)
PAM15 XPAM15	390	26	30	4	6	12	M6 (1/4-20 UNC)
PAM20 XPAM20	520	26	30	4	6	12	M6 (1/4-20 UNC)
PAM27 XPAM27	702	26	30	4	6	12	M6 (1/4-20 UNC)

Code PAM (Acier S 235 JR)
Code XPAM (Inox 316L).

PS PLAQUE SUPÉRIEURE

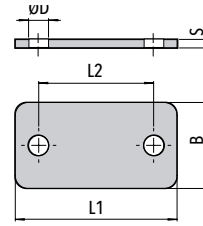

Code	L1	L2	B	S	ØD
------	----	----	---	---	----

PS3 XPS3	40,5	26	30	3	7
---------------------------	------	----	----	---	---

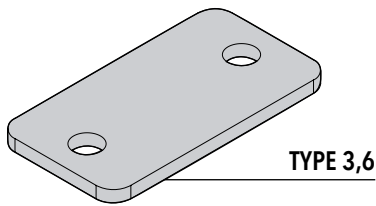

PS6 XPS6	69,5	52	30	3	7
---------------------------	------	----	----	---	---

Code PS (Acier S 235 JR)
Code XPS (Inox 316L)

62

VE VIS TÊTE H

ISO 4014 / 4017
POUR UTILISATION AVEC
PLAQUE SUPÉRIEURE PS

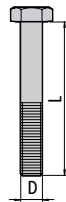

Code	Filetage (D x L)
------	---------------------

VE3 XVE3	M6x35 (1/4-20 UNCx1.3/8")
---------------------------	------------------------------

VE6 XVE6	M6x60 (1/4-20 UNCx2.3/8")
---------------------------	------------------------------

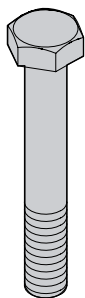

Code VE (Acier classe 8.8)
Code XVE (Inox A4)

TCEI VIS CHC

ISO 4762

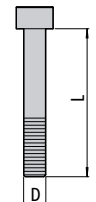

Code	Filetage (D x L)
------	---------------------

TCEI3 XTCEI3	M6x25 (1/4-20 UNCx1")
-------------------------------	--------------------------

TCEI6 XTCEI6	M6x50 (1/4-20 UNCx2")
-------------------------------	--------------------------

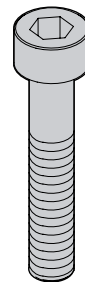

Code TCEI (Acier classe 8.8)
Code XTCEI (Inox 316L)

RP RONDELLE PLATE

UTILISATION AVEC VIS CHC TCEI

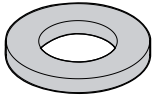
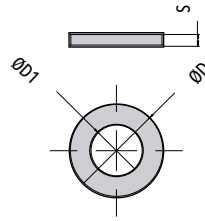

Code	ØD	ØD1	S
RP XRP	11,5	6,3	0,8

Code RP (Acier S 235 JR)
 Code XRP (Inox 316L)

MONTAGE EXEMPLE 01

Collier complet type S2 en Polypropylène pour tube de diamètre 18mm avec plaque à souder simple.

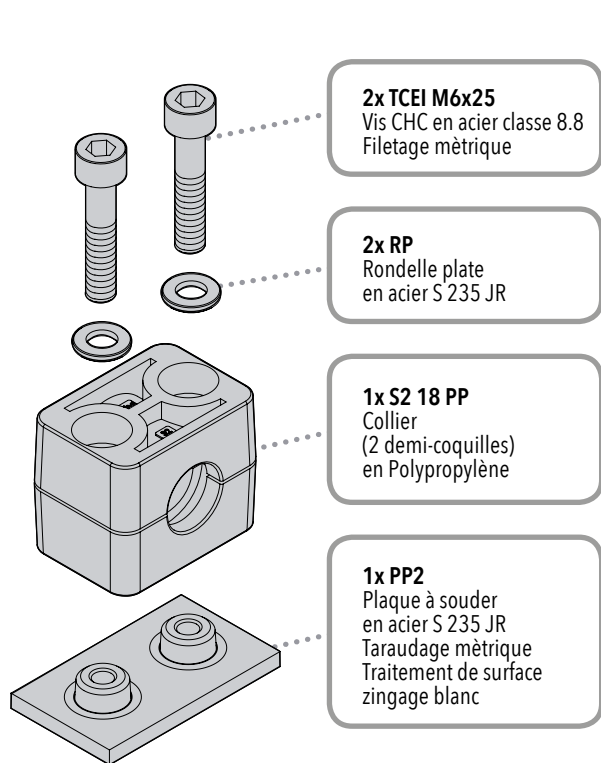

2x TCEI M6x25
Vis CHC en acier classe 8.8
Filetage métrique

2x RP
Rondelle plate
en acier S 235 JR

1x S2 18 PP
Collier
(2 demi-coquilles)
en Polypropylène

1x PP2
Plaque à souder
en acier S 235 JR
Taraudage métrique
Traitement de surface
zingage blanc

MONTAGE EXEMPLE 02

Collier complet type S3 en Polyamide pour tube de diamètre extérieur 30mm, avec plaque à souder multiple type cornière et plaque supérieure.

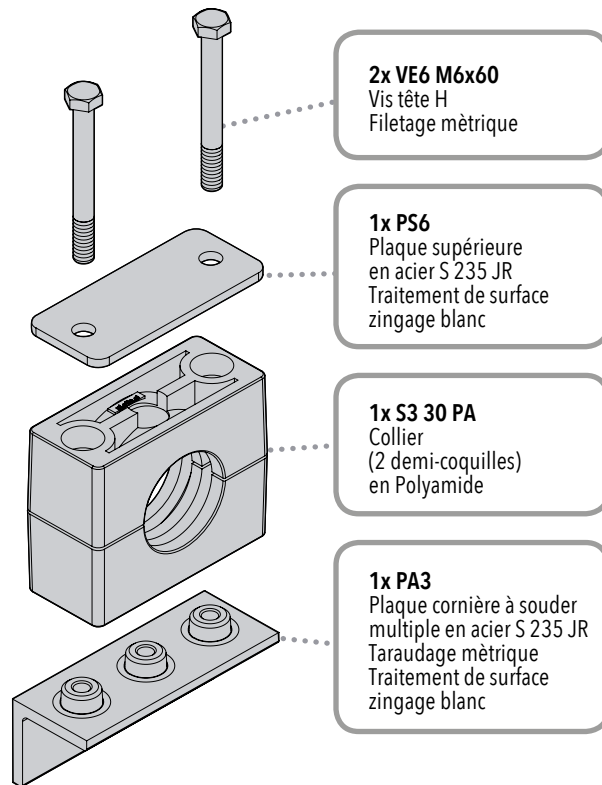

2x VE6 M6x60
Vis tête H
Filetage métrique

1x PS6
Plaque supérieure
en acier S 235 JR
Traitement de surface
zingage blanc

1x S3 30 PA
Collier
(2 demi-coquilles)
en Polyamide

1x PA3
Plaque cornière à souder
multiple en acier S 235 JR
Taraudage métrique
Traitement de surface
zingage blanc

MONTAGE EXEMPLE 03

Collier complet type S2 en Polypropylène pour tube de diamètre extérieur 18mm et 2 colliers complets type S3 en Polypropylène pour tube de diamètre extérieur 30mm avec plaque à souder multiple type cornière.

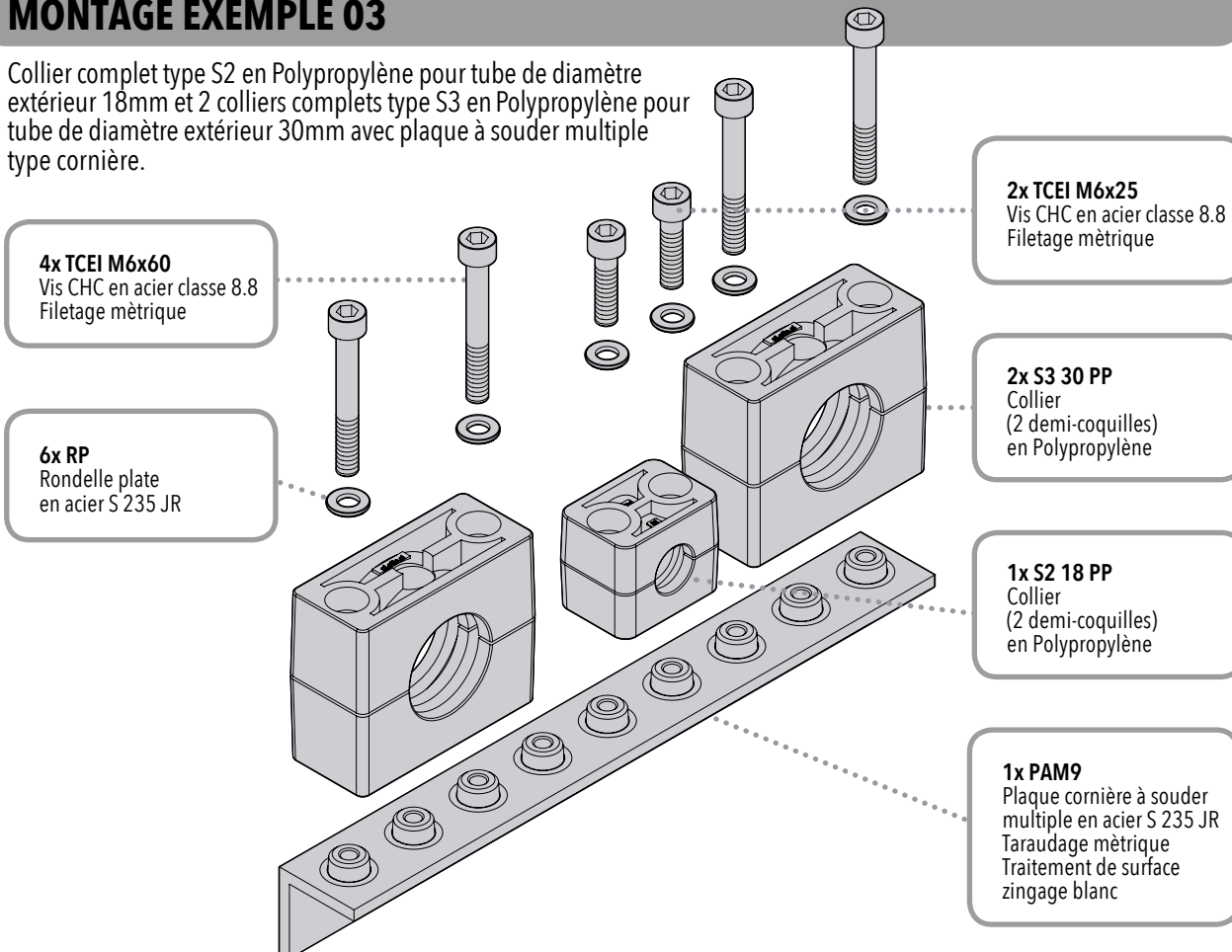

4x TCEI M6x60
Vis CHC en acier classe 8.8
Filetage métrique

6x RP
Rondelle plate
en acier S 235 JR

2x TCEI M6x25
Vis CHC en acier classe 8.8
Filetage métrique

2x S3 30 PP
Collier
(2 demi-coquilles)
en Polypropylène

1x S2 18 PP
Collier
(2 demi-coquilles)
en Polypropylène

1x PAM9
Plaque cornière à souder
multiple en acier S 235 JR
Taraudage métrique
Traitement de surface
zingage blanc